

Manufacturer's Recommendations

LOADS – Always use product within its stated Safe Working Load (SWL).

LIFTING & MOVEMENT – Do not use for lifting, such as in a crane or pulley situation, or for hanging services exhibiting movement or dynamic behavior. Designed for hanging statically positioned services only.

INSTALLATION: Do not walk or stand on the Gripple product installation.

PAINTING – Do not paint the Gripple Express fastener. Ensure that the fastener is in its final position prior to applying any paint to the cable assembly. Do not move Gripple fastener after painting.

CABLE – Always use Gripple supplied and specified cable. Never use on coated cable or other cable. Trim any damaged filaments with Gripple wire cutters before use.

ENVIRONMENT – Gripple products, including Stainless Steel, are NOT suitable for use in chlorinated / swimming pool environments. Use standard or Express Gripple hangers in **DRY LOCATIONS ONLY**. Stainless Steel Gripple hangers are **SUITABLE FOR DAMP LOCATIONS**.

LUBRICATION – Do not apply oil or any other lubricant to the Gripple fastener or any other part of the cable assembly.

JOINING – Never join two cable ends together in-line. Only pass the free end of the cable in a continuous loop through both channels of the Gripple fastener. The angle inside the Gripple formed loop must not exceed 60°.

HANGING AT AN ANGLE TO VERTICAL – Ensure that the load calculation considers the effect of 'side load'. For example, at an angle of 60° to vertical, the SWL is reduced by 50%. (See published technical information on website or in Product Guide.)

DUCTING: When installing wraparound hangers on round/spiral ducting or pipes, the final inclusive angle of the assembly should not exceed 60°.

Y-FIT: Legs on Y-Fit hangers are not be installed at angles greater than 60°.

Failure to comply with these recommendations may result in product malfunction and possible damage to property or person and will invalidate the Gripple warranty. Gripple products are warranted to conform to the manufacturer's published specifications at the time of shipment and to be free from defects in materials and workmanship. No other warranty, whether express or implied, including any warranty of merchantability or fitness for purpose, shall exist in connection with the sale or use of any Gripple product.

Safe Working Load

Size	Max Load (lbs)
No. 1	33
No. 2	100

Hanger Angles

If cable is suspended at an angle from vertical, an additional sideways load is applied which reduces the load capacity of the overall suspension. Please see published technical information regarding this net effect on Safe Working Load. Legs on Y-Fit hangers not to be installed at angles greater than 60°

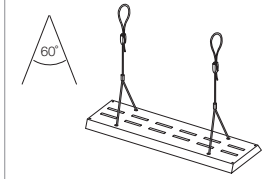

Install

1. Thread cable into No. 1 or No. 2 Gripple Express.
2. Pull cable through.

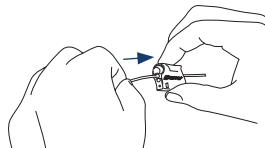

3. Loop around ceiling or service attachment point and pass tail end of cable through other hole of Gripple Express.

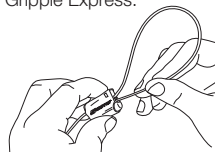

Release

1. Make sure load is supported.
2. Press the button on the top (Gripple Express No. 2) or slide the button on the side (Gripple Express No. 1), to release the Gripple Express fastener from the cable and adjust the height of the service.

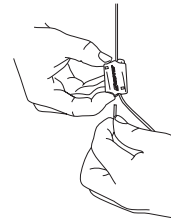

For further technical assistance, please contact:

Gripple Inc. 1611 Emily Lane / Aurora, IL 60502 Phone: 630.406.0600 Email: gripplecnc@gripple.com

LOOP

For choking around bar joists, beams, and roof trusses.

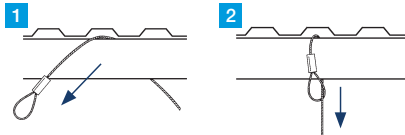

HOOK / Y-HOOK

For snapping onto light fixtures, beam & purlin clips, or cable basket & tray.

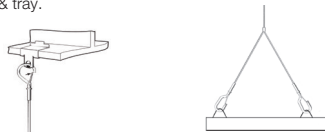

BARREL

For attaching to a 1/4" male thread product.



STUD

For anchoring into concrete ceilings, and metal decking or brackets



EYELET

For bolting to fixtures or services, wood beams, or brackets.



V-BRACKET ACCESSORY

Front or side mount light fixture clip for fluorescent light fixtures.

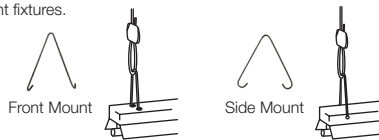

TOGGLE / Y-TOGGLE

For inserting into pre-drilled holes of light fixtures or metal decking

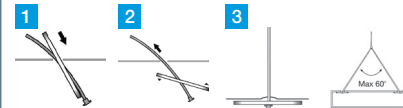

90° EYELET

For shot firing into concrete or steel. Can be used with mechanical anchors.



For further technical assistance,
please contact:

Gripple Inc.

1611 Emily Lane / Aurora, IL 60502

Phone: 630.406.0600

Email: grippleinc@gripple.com

www.gripple.com/us



UL File No. E228153	No. 1 Up to 25 lbs	No. 2 26-100 lbs
Loop	✓	✓
Stud*	✓	✓
Toggle	✓	✓
Y-Fit	✓	✓

* Note: The suitability of the Stud end fixing for use in concrete was not part of UL investigation

** Y-Fit Hanger is not part of CSA approval



UL File No. E251132*	No. 2 26-100 lbs
Loop	✓

* EMT Conduit up to 6" diameter

Suitable for use in Air Handling Spaces in accordance with Section 300.22 (C) and (D) of the National Electrical Code, and rules 12-010 (3), (4), and (5), and 12-020 of the Canadian Electrical Code, Part 1.