

ACS Series Model No.

ACS-2020-IG-6C-HW

AC Power Strip w/Six Circuits



Six-circuit power strip with insulated ground (isolated ground or I.G.) receptacles is made to safely power equipment in installations that require multiple AC power circuits. Features 20 receptacles (10 duplex). Requires 35U panel space (minimum).

FEATURES

POWER RATING: 120VAC, 60Hz, 20A (each circuit)

CHASSIS: 60" x 2" x 2" steel chassis with black powder epoxy finish

TERMINATION: Hardwired non-metallic flexible conduit with pigtail leads rotates in any direction. It can be trimmed in the field if needed.

CIRCUITS & RECEPTACLES: A total of 20 I.G. receptacles (10 duplex) are wired into six independent circuits and grouped as shown in photo. Connections are made via pigtail leads that are tagged according to circuit.

- Circuit 1 powers three (3) NEMA 5-20R I.G. duplex receptacles
- Circuit 2 powers two (2) NEMA 5-20R I.G. duplex receptacles
- Circuit 3 powers two (2) NEMA 5-20R I.G. duplex receptacles
- Circuit 4 powers one (1) NEMA 5-20R I.G. duplex receptacle
- Circuit 5 powers one (1) NEMA 5-20R I.G. duplex receptacle
- Circuit 6 powers one (1) NEMA 5-20R I.G. duplex receptacle

UNIVERSAL MOUNTING BRACKETS: The universal brackets allow for power strip installation in a variety of applications with receptacles facing front, center or rear. Brackets are engineered with multiple mounting points and include two types of hardware to facilitate easy installation in a rack with adjustable or fixed rails, to a wall, or under a desk/counter. The brackets can be mounted so they are exposed for easy access or concealed beneath the power strip for an aesthetically cleaner installation.

CERTIFICATION: ETL Listed in U.S./Canada

ORIGIN: Assembled in U.S.A. with global components

A&E SPECIFICATIONS

The six-circuit power strip shall be Lowell model ACS-2020-IG-6C-HW, which shall feature 20 NEMA 5-20R insulated ground (isolated ground) receptacles (10 duplex) wired into six independent circuits. Circuit one shall have three grouped duplex receptacles; circuits two and three shall each have two grouped receptacles; circuits four, five and six shall each have one duplex receptacle. Termination shall be via a six-foot non-metallic flexible conduit with numbered pigtail leads. The steel chassis with black powder epoxy finish shall measure 60" x 2" x 2". It shall include universal mounting brackets and hardware. The power strip shall be ETL Listed and shall be made in the U.S.A. with global components.

UNIVERSAL MOUNTING BRACKETS: The brackets can be mounted exposed for easy access or concealed for a cleaner install. Includes variety of hardware for versatile installation.

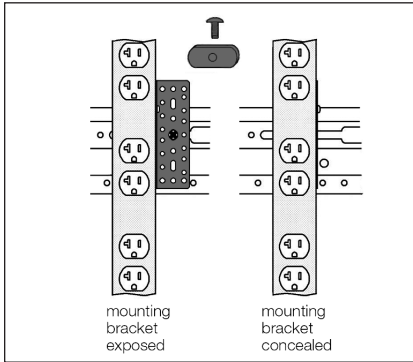
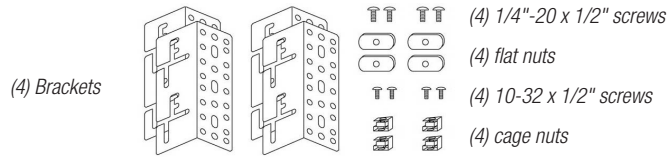

RACK w/ ADJUSTABLE RAILS
(side mount): Mount to horizontal side supports with universal brackets, 1/4"-20 screws, flat nuts.

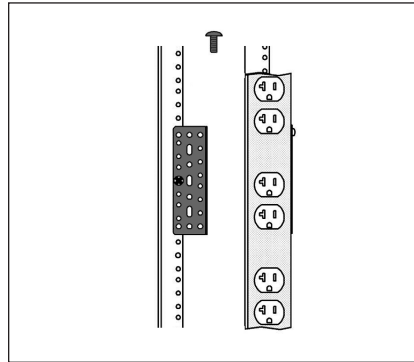

RACK w/ ADJUSTABLE RAILS
(rear mount): Mount to rear rail with universal brackets, 10-32 screws.

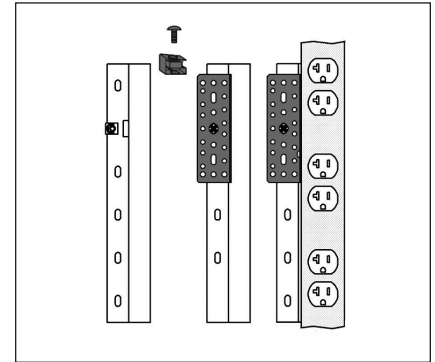

RACK w/ FIXED POSITION RAILS
(and rear Z-angle bracket): Mount to Z-angle with universal brackets, 10-32 screws, cage nuts.

HOW TO TRIM THE CONDUIT: The 6 ft. non-metallic flexible conduit can be trimmed in the field.

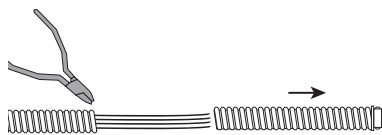

1) REMOVE EXCESS LENGTH:
Snip reinforcing rib at desired length. Bend the conduit to expose the cut and carefully cut around the conduit without cutting the wires inside. Remove excess length.

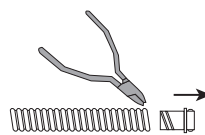

2) REMOVE CONNECTOR:
Carefully snip the last rib(s) to loosen the connector from the excess length, then twist/pull to remove it.



3) REATTACH CONNECTOR:
Twist/push the connector to attach it to the shortened conduit.

SERIES SUMMARY

Model No.	Power Rating	NEMA Receptacles	Circuits	Chassis Length	Chassis Profile	Termination	On/Off Switch	Surge Suppression	Remote Power Control	Mounting Aids	Country of Origin
ACS-1505-SW	15A	5 (15A)	1	12"	Standard	6' Det. cord	Yes	---	---	Brackets	U.S.
ACS-1505-SW-SD	15A	5 (15A)	1	12"	Standard	6' Det. cord	Yes	2-stage	---	Brackets	U.S.
ACS-1506	15A	6 (15A)	1	20"	Low	6' Fixed cord	---	1-stage	---	Clips	China
ACS-1506-WW	15A	6 (15A)	1	12"	Low	6' Fixed cord	---	---	---	Screws	U.S.
ACS-1507	15A	7 (15A)	1	12"	Low	6' Det. cord	---	---	---	Screws	U.S.
ACS-1512	15A	12 (15A)	1	32"	Low	12' Fixed cord	---	1-stage	---	Clips	China
ACS-1524	15A	24 (15A)	1	60"	Low	12' Fixed cord	---	1-stage	---	Clips	China
ACS-1524-2C	15A	24 (15A)	2	70"	Low	Pigtail leads	---	---	---	Clips	China
ACS-2012	20A	8 (15A) + 4 (20A)	1	32"	Low	12' Fixed cord	---	1-stage	---	Clips	China
ACS-2024	20A	16 (15A) + 8 (20A)	1	70"	Low	12' Fixed cord	---	1-stage	---	Clips	China
ACS-2014-HW	20A	14 (20A)	1	30"	Standard	6' Conduit	---	---	---	Brackets	U.S.
ACS-2014-2C-HW	20A	8 (15A) + 6 (20A)	2	30"	Standard	6' Conduit	---	---	---	Brackets	U.S.
ACS-2020-6C-HW	20A	20 (20A)	6	60"	Standard	6' Conduit	---	---	---	Brackets	U.S.
THIS SPEC  ACS-2020-IG-6C-HW	20A	20 (I.G. 20A)	6	60"	Standard	6' Conduit	---	---	---	Brackets	U.S.
ACS-2020-IG-10C-HW	20A	20 (I.G. 20A)	10	60"	Standard	6' Conduit	---	---	---	Brackets	U.S.
ACS-2024-2C	20A	24 (20A)	2	70"	Low	Pigtail leads	---	---	---	Clips	China
ACS-1510-RPC	15A	10 (15A)	1	30"	Standard	6' Det. cord	---	---	Yes	Brackets	U.S.
ACS-2010-RPC-HW	20A	10 (20A)	1	30"	Standard	6' Conduit	---	---	Yes	Brackets	U.S.
ACS-2018-5C-RPC-HW	20A	18 (20A)	5	60"	Standard	6' Conduit	---	---	Yes	Brackets	U.S.
ACS-2018-5C-RPCP-HW	20A	18 (20A)	5	60"	Standard	6' Conduit	---	1-stage	Yes (P)	Brackets	U.S.

Chassis Profile = Standard profile (2" x 2"), Low profile (1.625" x 1.375")

Termination = Det. cord (detachable cord), Fixed cord (cord is attached—cannot be removed), Conduit (non-metallic flexible whip w/pigtail leads), Pigtail leads (leads at ends of chassis—no whip)

Switch = Yes (On/off rocker switch)

Surge Suppression = 1-stage (basic surge protection), 2-stage (surge protection with backup)

Remote Power Control = Some receptacles are controlled by a remote switch or sequencer (ordered separately); (P) indicates compatibility with Lowell P-Series pass-through sequencers.

Mounting Aids = Brackets (multi-hole brackets with hardware), Clips (clips and screws with wire ties), or Screws (power strips can mount to rear of US or USV Series shelves).