

Model No. ACS-2020-10C-HW

AC Power Strip

20A, Multi-Circuit, Hardwired



Power strip with 20 (20A) outlets, 10 circuits and hardwired connections.

FEATURES

- Outlets: 20A NEMA 5-20R duplex receptacles.
- 10 independent circuits with 20A power rating for each circuit
- Chassis: Steel with black finish. 60 in. x 2 in. x 2 in.
- Termination: 6 ft. flexible (non-metallic) conduit with pigtail leads and a rotating connector on the chassis. Pigtail leads are tagged for easy identification of circuits 1-10.
- Universal mounting brackets with multiple mounting points facilitate easy installation in cabinets with adjustable or fixed mounting rails or to wall or desk surfaces. The brackets may be mounted so they are exposed for easy access or concealed under the strip for aesthetically clean installation.
- Made in USA with global components
- ETL Listed

A&E Specifications

ETL-Listed 20A power strip with ten independent circuits shall be Lowell Model ACS-2020-10C-HW with 20 (20A) NEMA 5-20R outlets. Power strip shall be made in the USA. It shall terminate via 6-foot non-metallic, flexible conduit with rotating connector and pigtail leads tagged for circuits 1-10. The chassis shall measure 60 in. x 2 in. x 2 in. and shall be steel construction finished in black powder epoxy paint. It shall include universal mounting brackets.

Model No. Summary

Model No.	Description	Outlets	Termination	NRTL	Chassis LxHxW
ACS-2020-10C-HW	AC Power Strip	20 I.G.	6-ft. flex conduit	ETL	60" x 2" x 2"

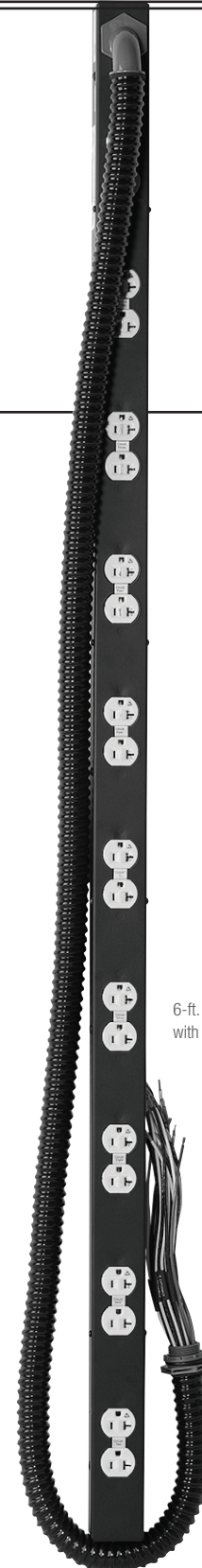

6-ft. non-metallic conduit with pigtail leads

Technical Drawings:

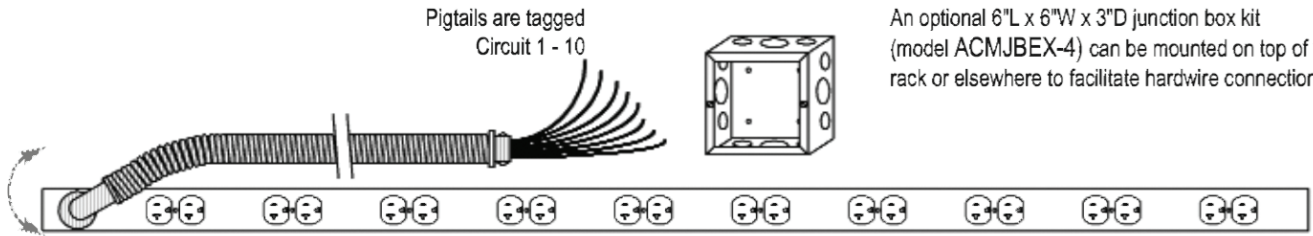

An optional 6"L x 6"W x 3"D junction box kit (model ACMJBEX-4) can be mounted on top of the rack or elsewhere to facilitate hardwire connections.

6-ft. flexible (non-metallic) conduit has a rotating connector.

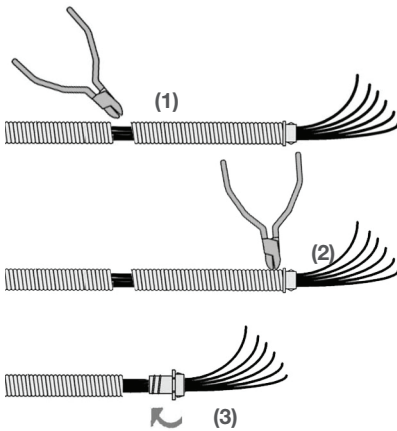
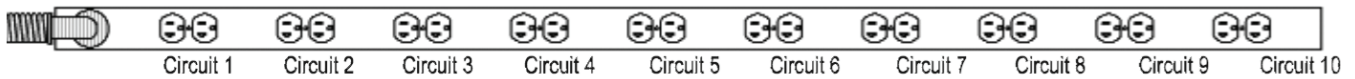

Non-metallic Flexible Conduit can be Trimmed in the Field

1. Snip reinforcing rib at desired length. Bend and carefully cut around conduit without cutting wires inside. Remove excess conduit.
2. Snip 2 or 3 ribs around the connector and remove connector from excess conduit.
3. Attach connector to shortened conduit length.

Universal Mounting Brackets

Brackets include multiple hardware sets for versatile installation.

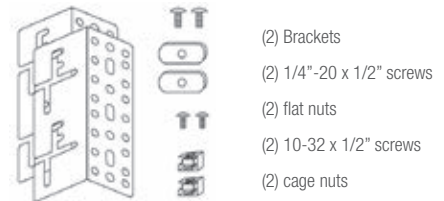

INSTALLATION:

For racks with adjustable mounting rails
(Side of rack, horizontal supports)

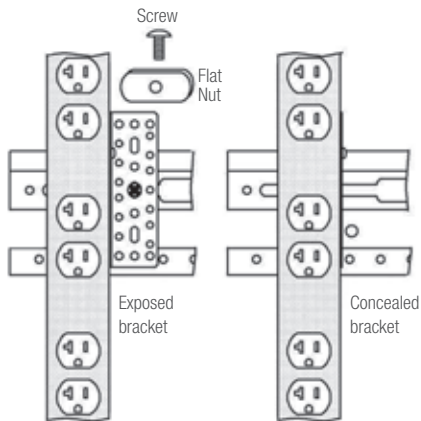

INSTALLATION:

For racks with adjustable mounting rails
(Rear rail)

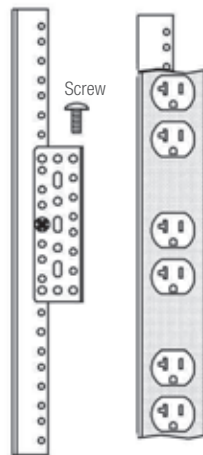

INSTALLATION:

For racks with fixed mounting rails
(Rear Z-angle)

