

Model No.

# TLM-1670A

High Performance Line Matching Transformer

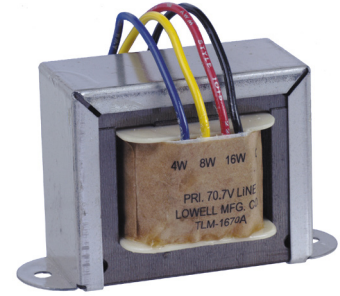

THE HIGH PERFORMANCE LINE MATCHING TRANSFORMER has a frequency response of 50Hz – 15kHz ( $\pm 1$ dB) and features color coded leads.

## FEATURES:

- Primary Voltage: 70V
- Power Rating: 16W
- Primary Taps: 16, 8, and 4W
- Secondary Impedance: 8, 4 ohms
- Frequency Response: 50Hz–15kHz ( $\pm 1$  dB)
- Leads: Color coded
- Lead Length: 18 inches

## A&E SPECIFICATIONS:

The line matching transformer shall be Lowell model TLM-1670A. Primary voltage shall be 70V with a power rating of 16 watts. Primary taps shall be available at 16, 8, and 4 watts. Secondary impedance taps shall be available at 8 ohms and 4 ohms. All taps shall have clearly marked color coded leads. Frequency response of the transformer shall be 50Hz–15kHz ( $\pm 1$ dB) with insertion loss not to exceed 0.76 dB.

## SERIES SUMMARY:

| Model No.  | Primary Voltage | Power Rating | Primary Taps     | Secondary Impedance | Core Size (in) | Insertion Loss | Frequency Response       | Lead Length (in) | Weight (lbs) |
|------------|-----------------|--------------|------------------|---------------------|----------------|----------------|--------------------------|------------------|--------------|
| TLM-1670A  | 70V             | 16W          | 16, 8, 4W        | 8, 4 ohms           | .875 x 1.25    | .76 dB         | 50Hz-15kHz ( $\pm 1$ dB) | 18               | 2            |
| TLM-3270A  | 70V             | 32W          | 32, 16, 8W       | 8, 4 ohms           | 1 x 1.5        | .77 dB         | 50Hz-15kHz ( $\pm 1$ dB) | 18               | 3.2          |
| TLM-10070A | 70V             | 100W         | 100, 64, 32, 16W | 8, 4 ohms           | 1.25 x 1.25    | .6 dB          | 50Hz-15kHz ( $\pm 1$ dB) | 18               | 4.45         |

THIS SPEC

**TECHNICAL DRAWINGS:**  
*Dimensions are inches and [mm] unless stated otherwise.*

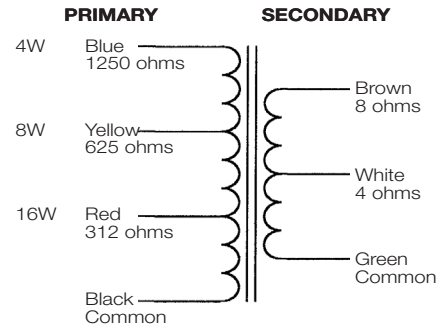
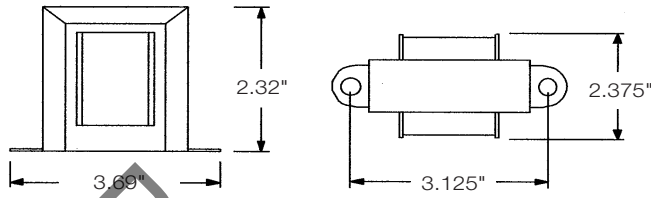

DISCONTINUED MODEL