

Model No.

RPS-TP

Thermal Switch Probe for Temperature Controlled Activation/Deactivation of Equipment

As an alternate to using manual RPS Series switches, the thermal switch probe can be used with Lowell classic connection devices (sold separately), to automatically control activation and deactivation of connected equipment in response to temperature fluctuations. Automatic activation is ideal for fans, lights, alarms, indicators, and similar equipment. See compatible classic connection devices below.

FEATURES

ACTIVATION: The thermal switch probe automatically activates connected equipment when the ambient temperature reaches 86°F [30°C] at probe's location.

DEACTIVATION: The thermal switch probe automatically deactivates connected equipment when the ambient temperature reaches 72°F [22°C] at probe's location.

EFFICIENT: Power-saving feature ensures efficient operation of equipment.

CORD: Six ft. long green cord (without plug)



A&E SPECIFICATIONS

The system shall include a thermal switch probe, Lowell model RPS-TP, which shall be used in conjunction with a Lowell classic connection device (SEQ, RPC, or RY Series, ordered separately) to control activation and deactivation of connected equipment in response to temperature fluctuations. The probe shall activate equipment when ambient temperature reaches 86 degrees Fahrenheit, and deactivate equipment when ambient temperature reaches 72 degrees Fahrenheit, at probe's location. It shall include a 6 ft. green cord (without plug).

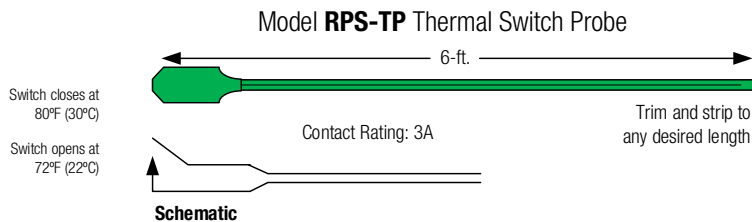

COMPATIBLE DEVICES

- Lowell stand-alone remote power controls (classic connections): RPC Series
- Lowell stand-alone sequencers (classic connections): SEQ Series
- Lowell relays (classic connections): RY-2A, RY-4A

SAMPLE INSTALL: Classic connection sequencer

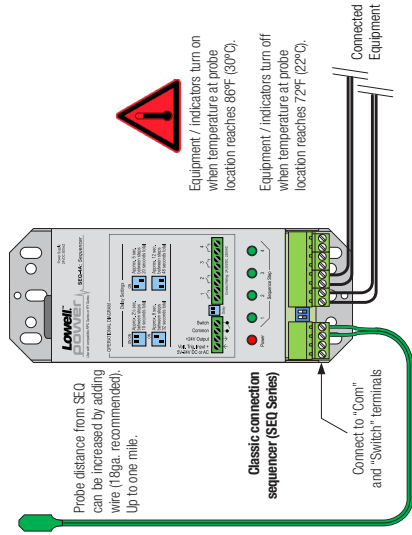

SAMPLE INSTALL: Classic connection remote power control

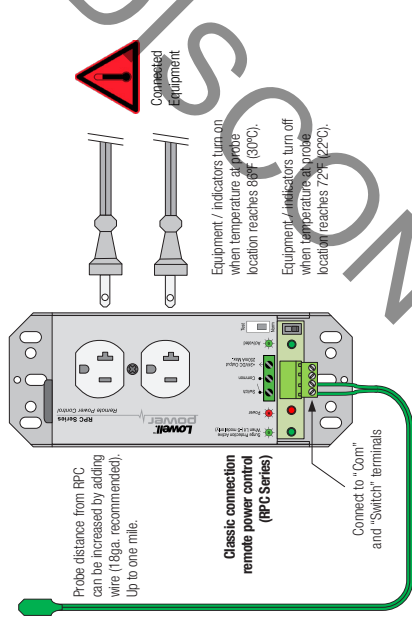

SAMPLE INSTALL: Classic connection relay module

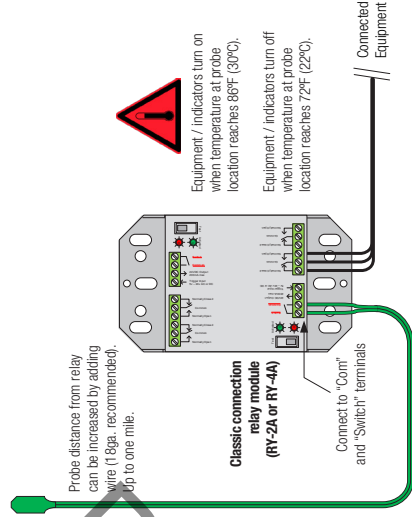

SAMPLE INSTALL: Remote sequential system

